

(I)

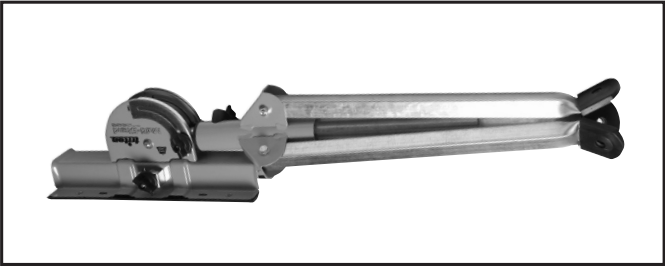

(II)



(III)



(IV)



(Fig. A)

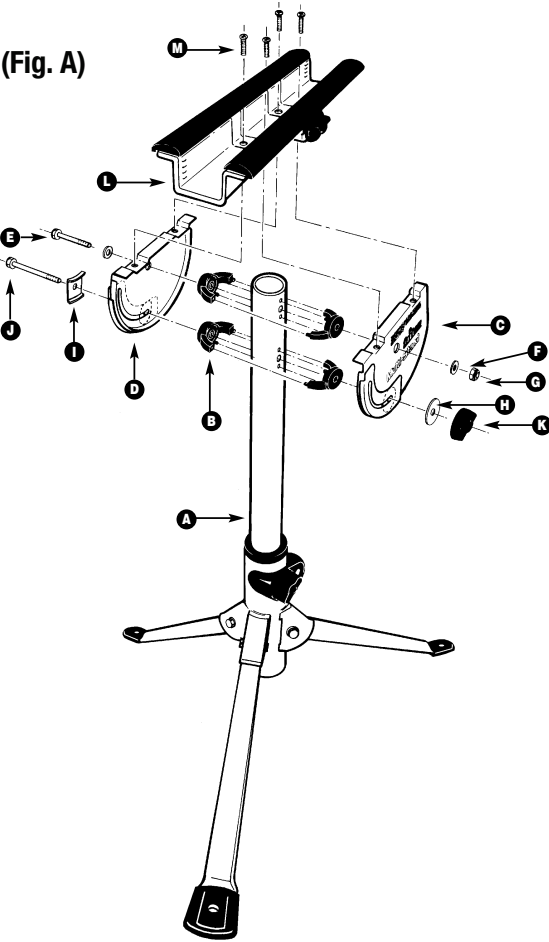

Thank you for purchasing this Triton tool. This manual contains information necessary for safe and effective operation of this product. This product has unique features and, even if you are familiar with similar products, it is necessary to read this manual carefully to ensure you fully understand the instructions. Ensure all users of the tool read and fully understand this manual.

Description of Symbols

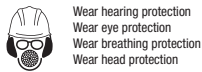

Wear hearing protection
Wear eye protection
Wear breathing protection
Wear head protection



Read instruction manual



Caution!



DO NOT use as a step or platform!

Specification

Model number:	MSA200
Max. load capacity:	100kg
Max. clamping capacity (jaw width):	51mm
Min. clamping width (min. workpiece thickness):	31mm
Min. height:	635mm
Max. height:	940mm
Clamping width (head length):	385mm
Tilt angle:	0-45°
Folded dimensions (L x W x H):	185 x 150 x 950mm
Weight:	6.2kg (13.7lbs)

Safety Instructions

Carefully read and understand this manual and any label attached to the tool before use. Keep these instructions with the product for future reference. Ensure all persons who use this product are fully acquainted with these instructions.

Even when following these instructions it is not possible to eliminate all residual risk factors. Use with caution. If you are at all unsure of the correct and safe manner in which to use this tool, do not attempt to use it.

- Do not force, or attempt to use a tool for a purpose for which it was not designed
- This tool is not intended for industrial use
- The use of any attachment or accessory other than those mentioned in this manual could result in damage or injury.
- The use of improper accessories could be dangerous, and may invalidate your warranty
- Where possible, always secure work. If appropriate use a clamp or vice, it will allow you to use both hands to operate your tool

Multi-Stand Safety

- ALWAYS ensure that the stand's legs are correctly extended, and that all clamping screws are fully tightened before applying heavy loads
- NEVER load the stand off-centre or in a manner that will cause an imbalance
- NEVER exceed the maximum load capacity (see 'Specification'). Doing so will damage your stand and may cause serious injuries
- DO NOT stand on this product
- DO NOT use this product for the construction of work platforms
- ALWAYS use a packing piece when clamping materials of less than 30mm thickness
- When clamping easily damaged materials, eg doors, use thin packing on both sides to avoid damage
- Ensure the stand is securely fastened down when applying non-vertical loads or when on sloping ground

Product Familiarisation

1. Tilt Head
2. Low-Friction Surfaces
3. Workpiece Clamping Screw
4. Tilt Head Clamping Screw
5. Column
6. Height Adjustment Clamping Screw
7. Rubber Coated Feet
8. Tripod Legs
9. Head Channel

Component List

Ref.	Description	Dimensions	Amount
A	Main Body Assembly		1
B	Saddles		4
C	Front Quadrant		1
D	Rear Quadrant		1
E	Hex Bolt	M6 x 60mm	1
F	Small Washer		2
G	Lock Nut	M6	1
H	Large Washer		1
I	Quadrant Washer		1
J	Hex Bolt	M6 x 80mm	1
K	Round Knob & Nut	M6	1
L	Head Assembly		1
M	Pan Head Bolt		4

Intended Use

This Triton Multi-Stand is a portable tripod workpiece support suitable for a multitude of different applications

Unpacking Your Tool

- Carefully unpack and inspect your tool. Fully familiarise yourself with all its features and functions
- Ensure that all parts of the tool are present and in good condition. If any parts are missing or damaged, have such parts replaced before attempting to use this tool

Before Use

Assembly

- The Triton Multi-Stand is easily assembled following the steps below:
- Fold the legs of the Main Body Assembly (A) fully outwards. Loosen the round knob and extend the stem upwards, then tighten

Note: The legs should pivot firmly. Adjust the nuts on the leg pivot bolts if necessary.

- Fit the Saddles (B) to the stem using the locating pins on the Saddles as shown
- Attach the Front Quadrant (C) and Rear Quadrant (D) using the shorter Hex Bolt (E), Small Washers (F) and Lock Nut (G).

WARNING: Do not over-tighten.

- Fit the Quadrant Washer (I) onto the longer Hex Bolt (J) with the hex head located in the tabs on the washer. Insert the bolt through the slots in the quadrants, ensuring that it passes through the washer held within each quadrant and the hole in the lower stem saddles. Fasten the Large Washer (H) onto the bolt with the Round Knob & Nut (K)
- Rotate the quadrants until the flat tops are horizontal then gently loosely tighten the Round Knob
- Fasten the Head Assembly (L) to the quadrants using the Pan Head Bolts (M). The round knob on the clamp which is built into the head should be on the same side as the round knob on the quadrant
- Adjust the nut tension on the Hex Bolt (E) if necessary. The head should pivot firmly, and should lock tightly at any selected angle when the quadrant knob is tightened

Folding and Unfolding

- The Triton Multi-Stand quickly and easily folds for convenient storage (Image I):
- Loosen the Height Adjustment Clamping Screw (6)
 - Slide the Column (5) in as far as it goes, and tighten the Height Adjustment Clamping Screw
 - Loosen the Tilt Head Clamping Screw (4), tilt the Tilt Head (1) into the vertical position
 - Fold in all three Tripod Legs (8)

Note: To unfold the Triton Multi-Stand, follow the above steps in reverse order.

Operation

Positioning and Adjusting

WARNING: Always use the Triton Multi-Stand in a stable position. If the ground is uneven or sloping, the stand must be secured to the ground by using suitable fasteners, such as screws, nails or pegs, through the holes in the Rubber Coated Feet (7).

- The Triton Multi-Stand features a Tilt Head (1) that can be adjusted horizontally (0°), vertically (90°), or in any angle between 0 and 90°:
- Loosen the Tilt Head Clamping Screw (4)
 - Adjust the Tilt Head (1) into the required position
 - Tighten the Tilt Head Clamping Screw

Clamping

- The inside surface of the Tilt Head (1) features an adjustable serrated clamp that can be used to hold a workpiece:
- Loosen the Workpiece Clamping Screw (3) to adjust the serrated clamp, so it fits the workpiece
 - Insert the work piece into the Head Channel (9) and close the Workpiece Clamping Screw tightly (Image II)

WARNING: The serrated clamp may leave an imprint on the workpiece when clamping. Use a shim or thin spacer between the serrated clamp and the workpiece, to keep it in pristine condition.

Use as Sliding Work Support

- The Triton Multi-Stand can be used as an infeed or outfeed support, sliding the workpiece over the horizontal low-friction surface of the Tilt Head (1)
- Where additional height is needed, clamp an object with smooth surface, e.g. a piece of wood, into the Tilt Head (as described in "Clamping"), to extend the height of the Triton Multi-Stand (Image III)

Building Work Supports

- Two or more Triton Multi-Stands can be used to build a variety of customised work supports (Image IV)

Accessories

- Visit your Triton dealer and www.tritontools.com to see the full range of Triton work supports and precision power tools

Maintenance

- Inspect the Triton Multi-Stand before every use. DO NOT use if any kind of damage is detected (deformation, corrosion, damaged welds etc.). The device may not be fit for service and needs to be inspected by a qualified Triton technician
- Clean the body of the Triton Multi-Stand with a soft brush or dry cloth
- If the Triton Multi-Stand has become wet, dry thoroughly before storage
- From time to time, or after contact with water, the clamping screws, column and tilting mechanism should be lightly lubricated with a suitable maintenance spray

Storage

- Store the Triton Multi-Stand carefully in a secure, dry place out of the reach of children

Warranty

Our goods come with guarantees that cannot be excluded under the Australian Consumer Law. You are entitled to a replacement or refund for a major failure and for compensation for any other reasonably foreseeable loss or damage. You are also entitled to have the goods repaired or replaced if the goods fail to be of acceptable quality and the failure does not amount to a major failure.

This product is covered by a 36 month warranty.

This warranty will not apply:

- (i) where this product has been subjected to misuse, abuse, accident or want of care;
- (ii) where this product has been used for a purpose for which it was not designed or is not suited;
- (iii) where the service of this product has been undertaken by a non-authorized person or company or if non-approved parts have been used;
- (iv) where this product has been used for industrial purposes.

Should service become necessary during the warranty period, the purchaser should contact an Authorised Service Centre or White International. In order to obtain warranty service, the purchaser must present the store receipt showing the name of the retailer and the date of purchase.

The period of the warranty begins from the original date of purchase, notwithstanding any subsequent repair or parts replacement.

Purchaser shall be responsible for all transport charges to and from the Authorised Service Centre.

Damage in transit is not covered by this warranty. The purchaser should remove from the product any liquids (if applicable) before sending the tool for service or repair. The tool should be packed securely to prevent damage.

Warranty Exclusions

Wear parts or service related parts required when performing normal and regular maintenance of this product are not covered by warranty unless it is found to be defective by an Authorised Service Centre. These include, but are not limited to: Blades Distributed in Australia by White International.

PO Box 304 Milperra LPO, NSW Australia, 2214

Ph:1800 251 338

The White International Policy is one of continuous improvement and the company reserves the right to alter designs, colours and specifications without notice

Guarantee

To register your guarantee visit our web site at www.tritontools.com* and enter your details.

Your details will be included on our mailing list (unless indicated otherwise) for information on future releases. Details provided will not be made available to any third party.

Purchase Record

Date of Purchase: ___ / ___ / ___

Model: MSA200 Retain your receipt as proof of purchase

Triton Precision Power Tools guarantees to the purchaser of this product that if any part proves to be defective due to faulty materials or workmanship within 3 YEARS from the date of original purchase, Triton will repair, or at its discretion replace, the faulty part free of charge.

This guarantee does not apply to commercial use nor does it extend to normal wear and tear or damage as a result of accident, abuse or misuse.

* Register online within 30 days.

Terms & conditions apply.

This does not affect your statutory rights

Notes

